

RIA

External intake and exhaust louvre



- Aluminium design
- Blades with drainage, preventing water ingress

TROX[®] TECHNIK

 **Auranor**

TROX Auranor Norge AS

PO Box 100
NO-2712 Brandbu

Telephone: +47 61 31 35 00

Fax: +47 61 31 35 10

e-mail firma@auranor.no

www.auranor.no

RIA



APPLICATION

RIA is an intake and exhaust louvre for external installation.

DESIGN

RIA-1 is made from extruded aluminium profiles, and is equipped with animal-proof netting. The RIA-2 design is identical to RIA-1, but without a flange. RIA-3 is made of aluminium, and has insulated blades and animal-proof netting. Wall-mounting frame with anchor is available for RIA-1.

MATERIALS AND SURFACE COATING

RIA-1 and RIA-2 are made from extruded profiles in seawater resistant aluminium (EN AW-5053 / 5754). Delivered untreated as standard. Anodized brown, black or natural are available on request. The louvres can also be supplied in enamel finish. Other materials available on request. RIA-3 is made of aluminium, and is insulated with Ecoson sound attenuation material. Enamel finish or alternative material available on request. Separate wall-mounting frame comes in an aluminium or galvanized steel design, and is equipped with anchor.

ORDER CODE, RIA

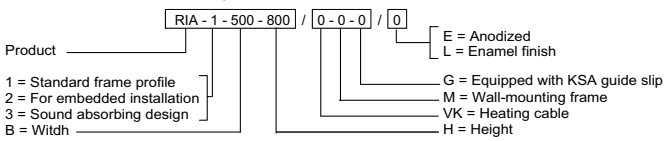

Example:
RIA-1-500-800 / 0-0-0 / 0
Explanation:
RIA-1 standard frame profile, 500 width, 800 height.

DIMENSIONS AND WEIGHT, RIA

Specified size = order dimensions (B x H). Products are supplied undersized for installation at duct end and/or in groove as illustrated in figures: B-4 and H-4.

Weight: RIA-1 and 2, approx. 15kg/m² without wall-mounting frame and 20 kg/m² with wall-mounting frame. RIA-3 approx. 45 kg/m².
Max dim. RIA-1, RIA-2 and RIA-3, not split: 2400 x 2400 mm.

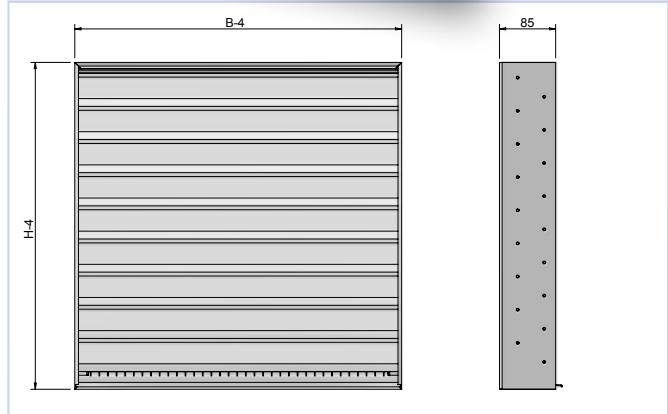

Figur 2, RIA-2

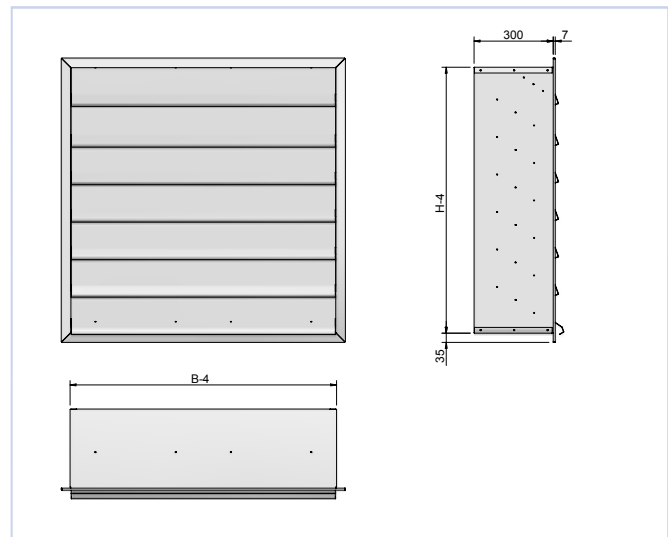

Figur 3, RIA-3

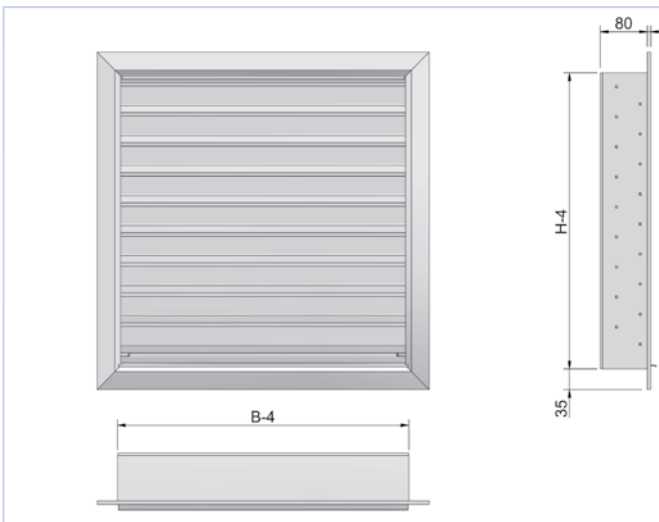

Fig. 1, RIA-1

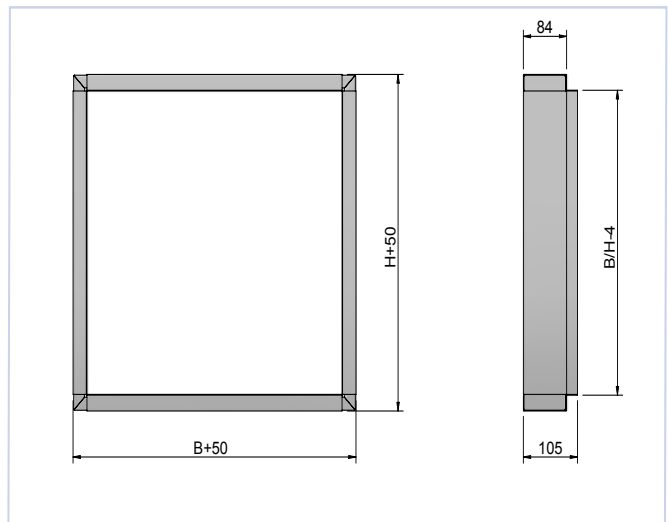

Fig. 4: Wall-mounting frame for RIA-1

RIA

■ CALCULATION DIAGRAM

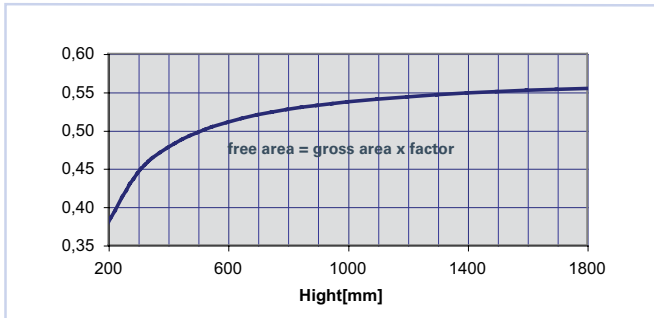

Diagram 1: RIA-1 and RIA-2

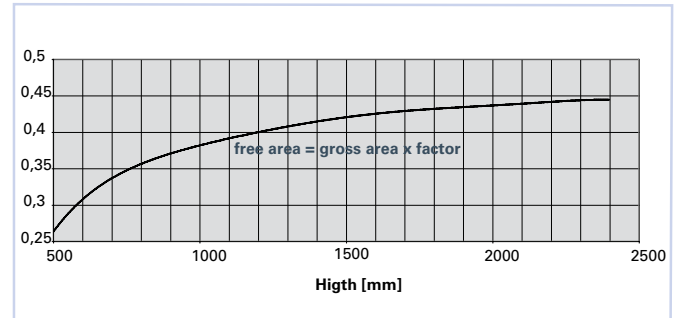

Diagram 2, RIA-3

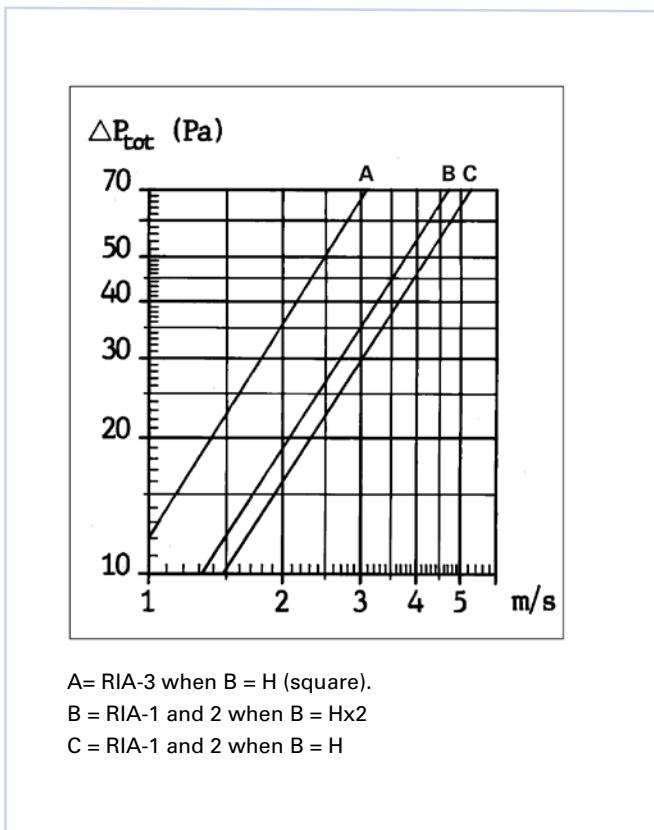

Diagram 3, RIA

RIA

INSTALLATION

For installation without wall-mounting frame, the minimum groove dimensions required are: B x H.
If a wall-embedded mounting frame is used, the groove-size required is: B+60 x H+60 mm.
During sealing, the mounting frame requires bracing.
For areas exposed to harsh weather conditions, max. recommended air face velocity is 2 m/s.

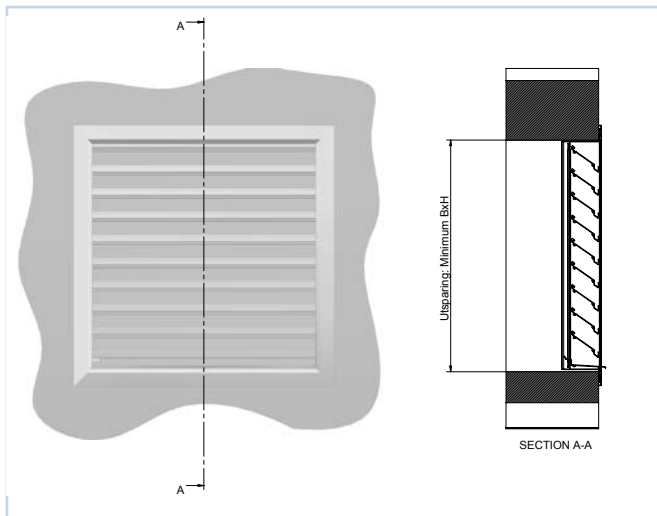

Fig. 5: RIA -1 standard design

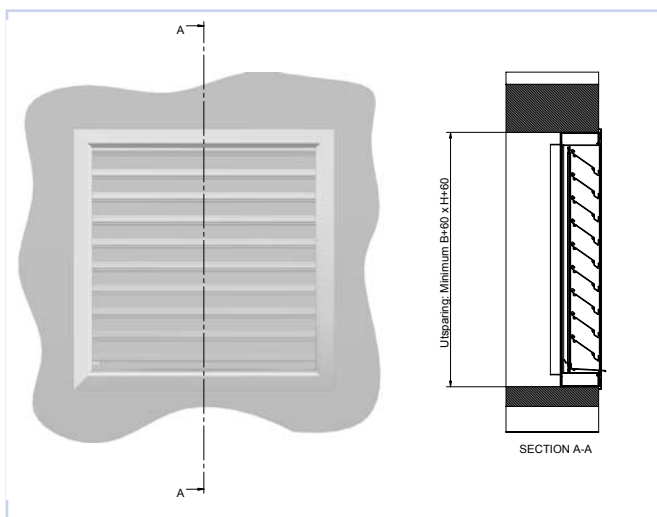

Fig. 6, RIA -1 with wall-embedded mounting frame

MAINTANCE

Leaves and dirt must be removed in order to avoid clogging.

ENVIRONMENT

Enquiries regarding product declaration can be directed to our sales team, or information can be found at our website: www.auranor.no

RIA is developed and manufactured by:

The company reserves the right to make amendments without prior notice.